

SAW Filter 2441.8MHz for Bluetooth
Part No: MA05253

Model: TA0223A
Rev No: 2

A. MAXIMUM RATING:

1. Input Power Level: 10dBm
2. DC voltage: 0V
3. Operating Temperature: -40°C to +85°C
4. Storage Temperature: -40°C to +85°C

B. ELECTRICAL CHARACTERISTICS:

| Item | Min. | Typ. | Max. |
|---|------|--------|------|
| Center frequency Fc (dB) | - | 2441.8 | - |
| Insertion loss (2400 ~ 2483.5MHz) IL (dB) | - | 2.1 | 5.0 |
| Amplitude ripple (2400 ~ 2483.5MHz) (dB) | - | 0.9 | 3.0 |
| Attenuation (Reference level from 0dB) | | | |
| DC ~ 1700MHz (dB) | 20.0 | 29.0 | - |
| 1700 ~ 2200MHz (dB) | 25.0 | 30.0 | - |
| 2700 ~ 3100MHz (dB) | 30.0 | 40.0 | - |
| 3100 ~ 4000MHz (dB) | 20.0 | 29.0 | - |
| 4000 ~ 5000MHz (dB) | 10.0 | 20.0 | - |
| VSWR (2400 ~ 2483.5MHz) | - | 1.7 | 2.6 |
| Source impedance Z _S (Ω) | - | 50 | - |
| Load impedance Z _L (Ω) | - | 50 | - |

Note1: The standard definitions is in JIS C 6703

SAW Filter 2441.8MHz for Bluetooth
Part No: MA05253

Model: TA0223A
Rev No: 2

C. MEASUREMENT CIRCUIT:

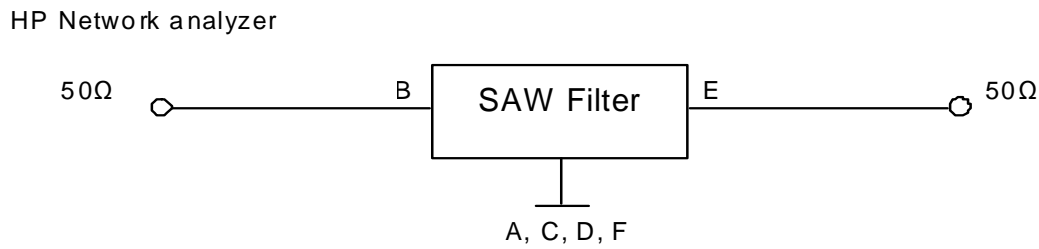

D. OUTLINE DRAWING:

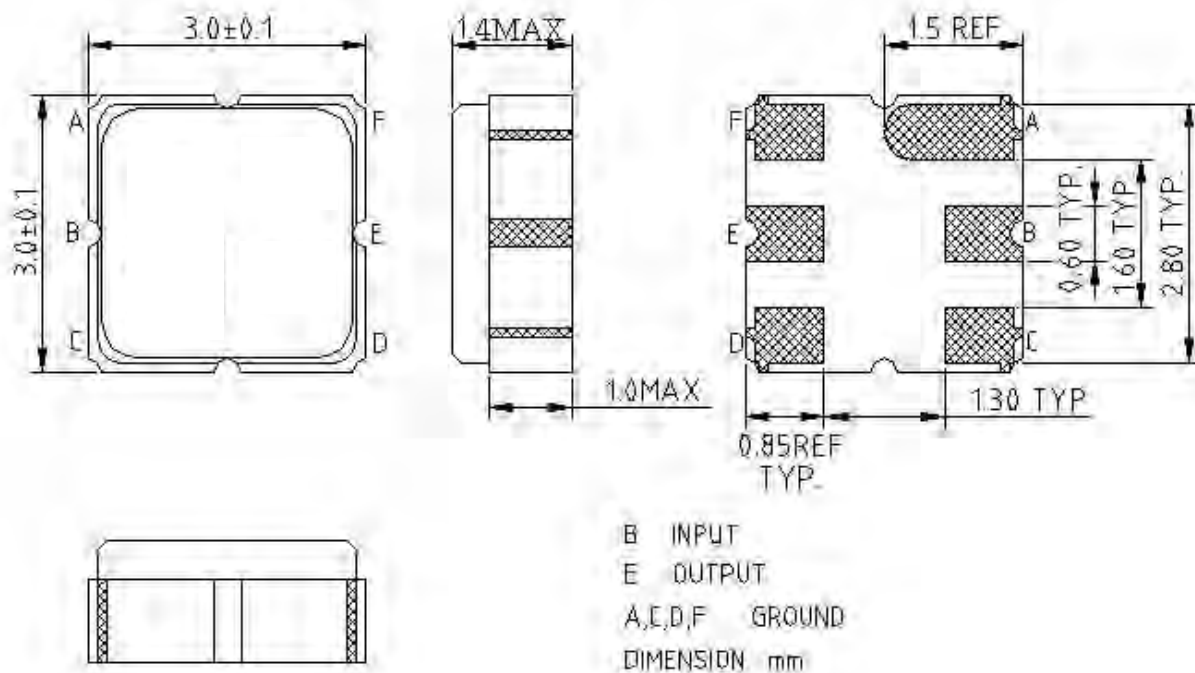

SAW Filter 2441.8MHz for Bluetooth
Part No: MA05253

Model: TA0223A
Rev No: 2

E. FREQUENCY CHARACTERISTICS:

Transfer function

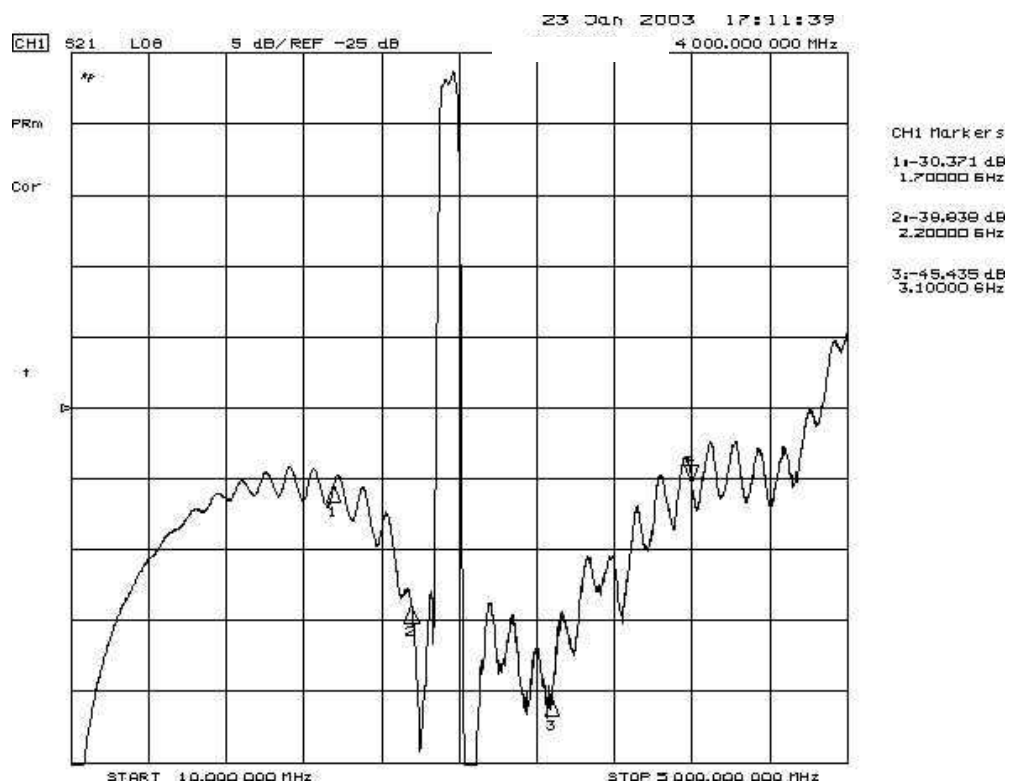
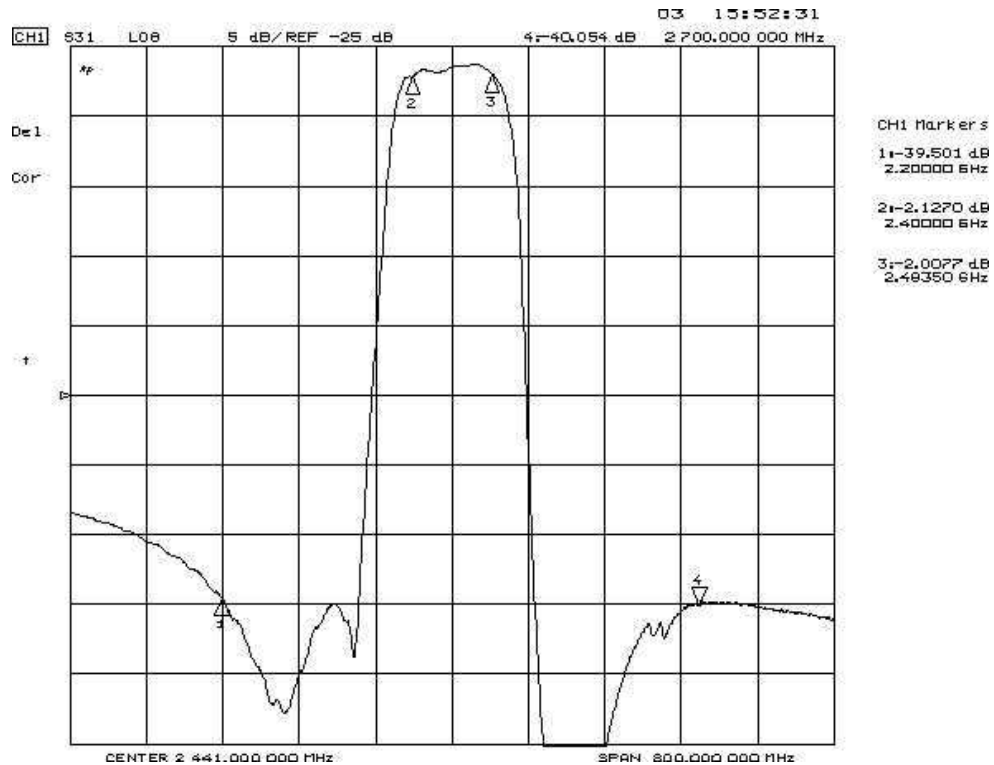

SAW Filter 2441.8MHz for Bluetooth
Part No: MA05253

Model: TA0223A
Rev No: 2

Reflections Functions

S11 VSWR

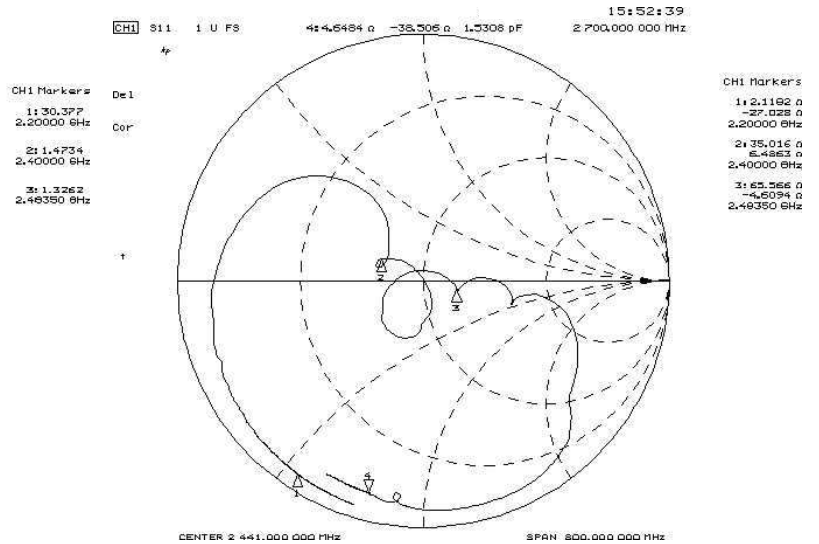
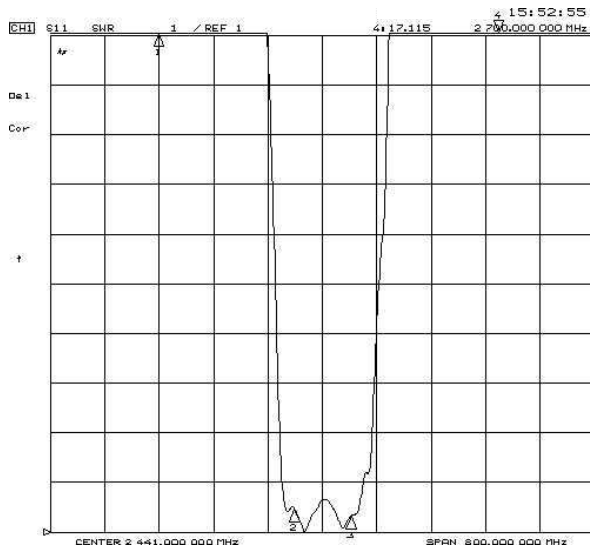

S22 VSWR

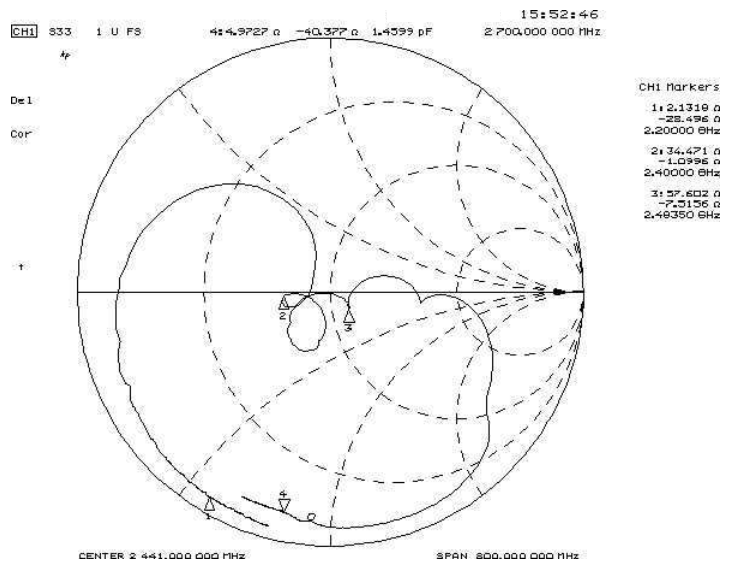
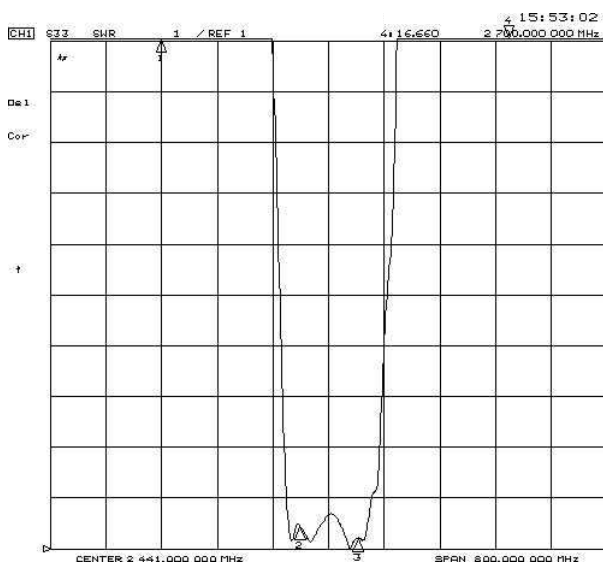

SAW Filter 2441.8MHz for Bluetooth
Part No: MA05253

Model: TA0223A
Rev No: 2

F. PACKING:

1. REEL DIMENSION

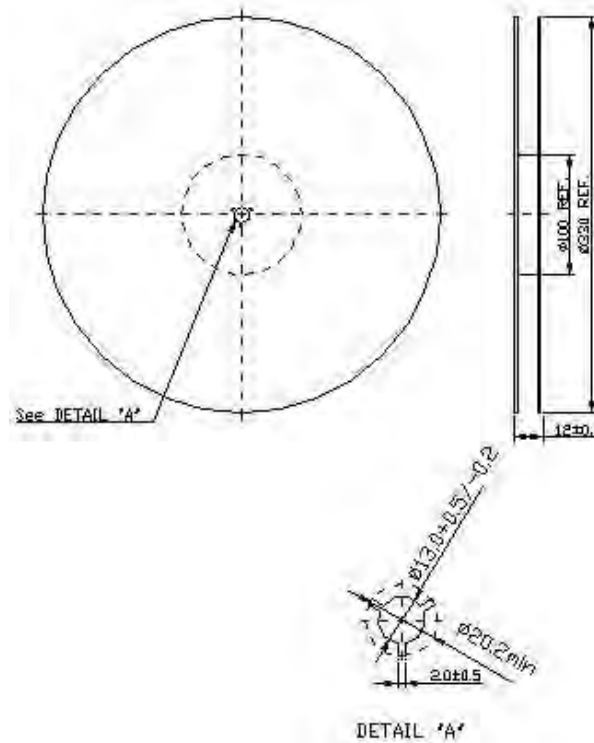

2. TAPE DIMENSION

